



Property Report for Parcel#: 471236 Existing

Friday, September 11, 2020

Parcel Information

Address: MOHAR RD CLE ELUM
 Tax Parcel ID: [471236](#)
 Map Number: 19-15-04040-0010
 Recorded Area:
 Owner Name BURCHAK, GEORGE & DIANE
 Name Cont:
 Mailing Address: 1941 MOHAR RD
 City/State/Zip: CLE ELUM WA 98922-8972

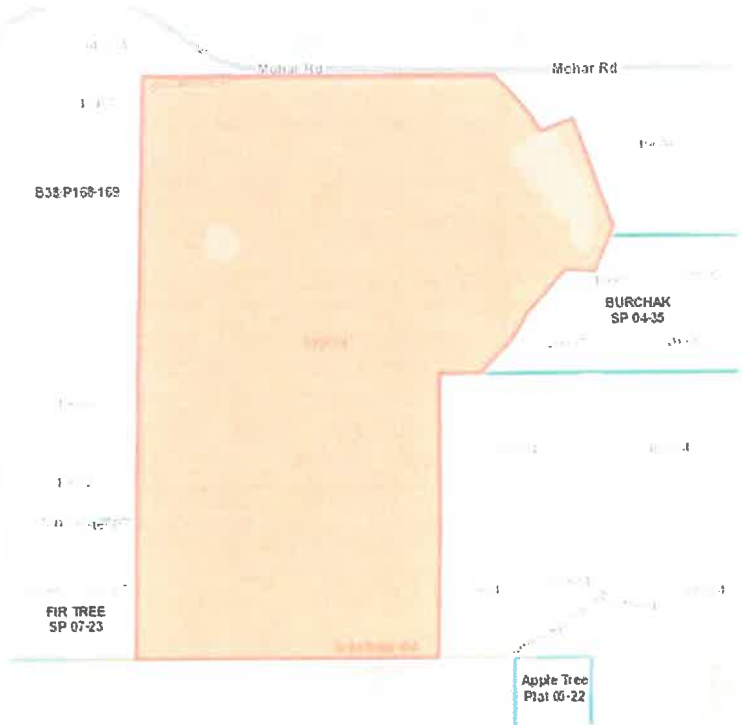

Critical Areas Information

Contains > 30% Slope: No
 PHS Site Name: N/A
 Roof Hazard: HIGH_EXTREEME HAZARD RATING
 Roof Class: CLASS A
 Seismic Category: D1
 Shore Line: N/A
 Wetland Code: PUBHx, PEMC
 DNR Water Type: Type 4, Type 9
 FIRM Zone: ZONE C
 FEMA Flood Map: 5300950244B, 5300950242B
 Coalmine Shaft: N/A
 Airport Zone: N/A
 BPA Right of Way: -1
 Max Elevation: 2314
 ISO: 0.059
 PG: .137, Engineering is required

Administrative Information

Zone and Allowed Uses: [Rural 5](#)
 Land Use Category: Rural Residential, [Allowed Use](#)
 Commisioner District:
 Voter Precinct: Westside
 Hospital District: HOSPITAL DISTRICT 2
 School District: Cle Elum-Roslyn School District
 Irrigation District: N/A
 Weed District:
 Fire District: Fire District 7 (Cle Elum)
 Cemetary District: N/A
 Court District: Upper District Court
 PUD Comm District: District 2
 Parks and Rec District: District 1
 Wildland Urban Interface: [IR 1](#)
 Stock Restricted Area: Stock Restricted
 COE Gas Service Area: No

Domestic Water Information

Groundwater Permit Required? No, [Suitability Map](#)
 Qualifying Water Banks: Burchak, Swiftwater Ranch
 Sub Basin Watershed: Kachess Yakima River

RECEIVED
 NOV 05 2020
 Kittitas Co. CDS